

## 6 Height adjustment

For square, rectangular, triangular, oval, and round tubes. Height adjustment for wooden furniture.



**YG2**

Page: 2



**JLR**

Page: 3



**JXB**

Page: 4



**JXF 1**

Page: 5



**JXF 2**

Page: 6



**JXL**

Page: 7



**JXM**

Page: 8



**JL 1**

Page: 9



**JL 2**

Page: 10



**JL 3**

Page: 11



**JLA 1**

Page: 12



**JLA 3**

Page: 13



**JXQ 1**

Page: 14



**JXQ 2**

Page: 15



**JXV**

Page: 16

## Non-slip plugs

YG2

Application:

Material: polyethylene

Standard-Colour: uncolored

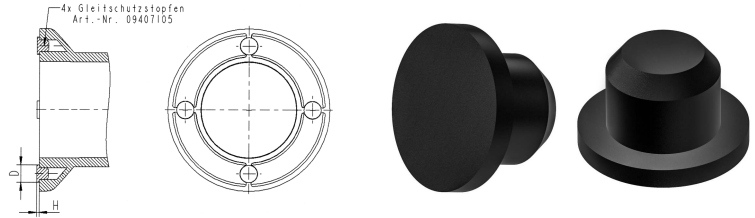

Order No.	Head $\varnothing$	Head height	For drilled hole $\varnothing$	Colour	PU*	MOQ**
13735.01	7,5	1,0	5,0	nature	2500	-

Please note that the product illustrations are exemplary images that could deviate from the ordered/delivered products.

All of the dimensions are in mm should nothing to the contrary be stated.

\*PU = Packaging Unit, SW = Spanner opening, n.w. = not detachable, o. K. = excl. The head, o. B. = excl. The collar, m. R. = with the radius, MOQ = Minimum Order Quantity.

\*\* MOQ: Parts with MOQ, set-up costs may apply.

We exclusively sell to the trade and industry. Please note our minimum order quantities and the minimum order value per delivery. We would be pleased to send you an offer that is tailored to your needs should you require special colours, deviating dimensions, bioplastics, or larger order quantities.

## Adjustable feet with plastic thread

Application: for round tubes  
Material: polyamide  
Standard-Colour: black

JLR

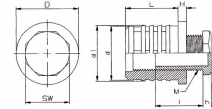

Order No.	Tube outside Ø	Height	Ribs Ø	Length	Adjusting screw	SW	Colour	PU*	MOQ**
	D	H	d1 / d	L	M x l x h				
12985.00	20x1-1,5	5,0	19,0 / 16,0	33,0	12x27x5,0	19	black	2000	-
12986.00	22x1,5-2	5,0	20,5 / 17,5	33,0	12x27x5,0	19	black	4000	4000
12987.00	25x1-2	5,0	23,5 / 19,5	33,0	12x27x5,0	19	black	1500	-
12988.00	28x1-2	5,0	26,5 / 22,5	33,0	16x31x5,0	27	black	1250	-
12989.00	30x1,5-2	5,0	29,0 / 25,5	26,0	22x29x5,0	27	black	1250	-
12990.00	32x1-2	5,0	29,5 / 27,0	33,0	22x29x5,0	27	black	1000	-
12991.00	35x1-2	5,0	33,5 / 29,0	33,0	22x29x5,0	27	black	900	-
12992.00	38x1,5-2	5,0	34,5 / 33,0	33,0	22x29x5,0	27	black	750	-
12993.00	40x1-2	5,0	38,5 / 36,0	33,0	22x29x5,0	27	black	600	-
12994.00	42x1,5-2	5,0	40,5 / 37,0	33,0	22x29x5,0	27	black	600	-
12995.00	45x1,5-2	5,0	41,5 / 40,5	33,0	22x29x5,0	27	black	500	-
12996.00	50x1,5-2	5,0	47,5 / 43,5	33,0	22x29x5,0	27	black	400	-

Please note that the product illustrations are exemplary images that could deviate from the ordered/delivered products.

All of the dimensions are in mm should nothing to the contrary be stated.

\*PU = Packaging Unit, SW = Spanner opening, n.w. = not detachable, o. K. = excl. The head, o. B. = excl. The collar, m. R. = with the radius, MOQ = Minimum Order Quantity.

\*\* MOQ: Parts with MOQ, set-up costs may apply.

! We exclusively sell to the trade and industry. Please note our minimum order quantities and the minimum order value per delivery. We would be pleased to send you an offer that is tailored to your needs should you require special colours, deviating dimensions, bioplastics, or larger order quantities.

## Height adjustment with movable base

Application: for round tubes  
Material: polyamide GF  
Standard-Colour: black

JXB

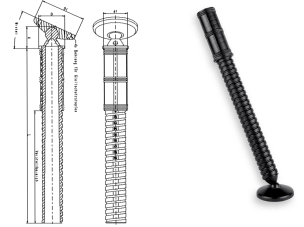

Order No.	Tube outside Ø	Rib Ø	Screwed in height	Adjusting angle	Base outside Ø	Total length L	Adjustment range	Colour	PU*	MOQ**
	D	d1	H		D1	L				
13042.00	40x1,5	37,3	34,0	0-40°	68,0	270,0	170	black	80	-
13093.00	40x1,5	37,3	34,0	0-40°	68,0	185,0	100	black	80	240
13046.00	40x2	36,5	34,0	0-40°	68,0	270,0	170	black	80	80
13095.00	40x2	36,5	34,0	0-40°	68,0	185,0	100	black	100	400
13094.00	42x1,5	39,3	34,0	0-40°	68,0	185,0	100	black	100	400
13096.00	42x2	38,3	34,0	0-40°	68,0	185,0	100	black	100	400

Please note that the product illustrations are exemplary images that could deviate from the ordered/delivered products.

All of the dimensions are in mm should nothing to the contrary be stated.

\*PU = Packaging Unit, SW = Spanner opening, n.w. = not detachable, o. K. = excl. The head, o. B. = excl. The collar, m. R. = with the radius, MOQ = Minimum Order Quantity.

\*\* MOQ: Parts with MOQ, set-up costs may apply.

We exclusively sell to the trade and industry. Please note our minimum order quantities and the minimum order value per delivery. We would be pleased to send you an offer that is tailored to your needs should you require special colours, deviating dimensions, bioplastics, or larger order quantities.

## Height adjustment with fixed large base

Application: for round tubes  
Material: polyamide GF  
Standard-Colour: black

JXF 1

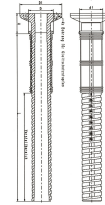

Order No.	Tube outside Ø	Rib Ø	Screwed in spindle	Base outside Ø	Total length	Max. adjustment range	Colour	PU*	MOQ**
	D	d1	H	D1	L				
12997.00	40 x 1,5	37,3	20,5	68,0	283,5	170	black	50	450
13082.00	40 x 1,5	37,3	20,5	68,0	198,5	100	black	100	-
13000.00	40 x 2	36,5	20,5	68,0	283,5	170	black	50	450
13084.00	40 x 2	36,5	20,5	68,0	198,5	100	black	100	300
12998.00	42 x 1,5	39,3	20,5	68,0	283,5	170	black	50	250
13083.00	42 x 1,5	39,3	20,5	68,0	198,5	100	black	100	300
13085.00	42 x 2	38,3	20,5	68,0	198,5	100	black	100	400

Please note that the product illustrations are exemplary images that could deviate from the ordered/delivered products.

All of the dimensions are in mm should nothing to the contrary be stated.

\*PU = Packaging Unit, SW = Spanner opening, n.w. = not detachable, o. K. = excl. The head, o. B. = excl. The collar, m. R. = with the radius, MOQ = Minimum Order Quantity.

\*\* MOQ: Parts with MOQ, set-up costs may apply.

We exclusively sell to the trade and industry. Please note our minimum order quantities and the minimum order value per delivery. We would be pleased to send you an offer that is tailored to your needs should you require special colours, deviating dimensions, bioplastics, or larger order quantities.

## Height adjustment with fixed small base

Application: for round tubes  
Material: polyamide GF  
Standard-Colour: black

JXF 2

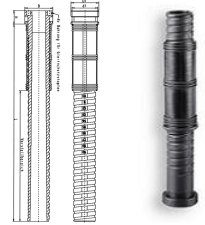

Order No.	Tube outside $\varnothing$	Rib $\varnothing$	Screwed in spindle	Base outside $\varnothing$	Total length	Max. adjustment range	Colour	PU*	MOQ**
	D	d1	H	D1	L				
13105.00	40 x 1,5	37,3	20,5	40,0	283,5	170	black	100	-
13123.00	40 x 1,5	37,3	20,5	40,0	198,5	100	black	100	500
13107.00	40 x 2	36,5	20,5	40,0	283,5	170	black	100	-
13125.00	40 x 2	36,5	20,5	40,0	198,5	100	black	100	-
13106.00	42 x 1,5	39,3	20,5	40,0	283,5	170	black	50	250
13124.00	42 x 1,5	39,3	20,5	40,0	198,5	100	black	50	250
13108.00	42 x 2	38,3	20,5	40,0	283,5	170	black	50	400
13126.00	42 x 2	38,3	20,5	40,0	198,5	100	black	50	400

Please note that the product illustrations are exemplary images that could deviate from the ordered/delivered products.

All of the dimensions are in mm should nothing to the contrary be stated.

\*PU = Packaging Unit, SW = Spanner opening, n.w. = not detachable, o. K. = excl. The head, o. B. = excl. The collar, m. R. = with the radius, MOQ = Minimum Order Quantity.

\*\* MOQ: Parts with MOQ, set-up costs may apply.

We exclusively sell to the trade and industry. Please note our minimum order quantities and the minimum order value per delivery. We would be pleased to send you an offer that is tailored to your needs should you require special colours, deviating dimensions, bioplastics, or larger order quantities.

## Height adjustment

Application: for round tubes  
Material: acrylonitrile butadiene styrene  
Standard-Colour: black

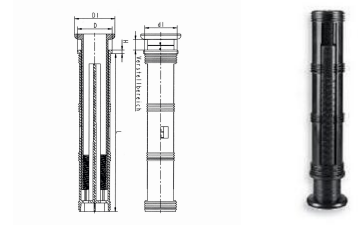

Order No.	Tube outside Ø	Rib Ø	Flange height	Base outside Ø	Adjustment range	Colour	PU*	MOQ**
	D	d1	H	D1				
13043.00	60x1,5	57,3	6,0	70,0	0-200	black	50	-
13047.00	60x2,0	56,3	6,0	70,0	0-200	black	50	-
12999.00	60x1,5	57,3	6,0	SW 60	0-200	black	50	250
13003.00	60x2,0	56,3	6,0	SW 60	0-200	black	50	-

Please note that the product illustrations are exemplary images that could deviate from the ordered/delivered products.

All of the dimensions are in mm should nothing to the contrary be stated.

\*PU = Packaging Unit, SW = Spanner opening, n.w. = not detachable, o. K. = excl. The head, o. B. = excl. The collar, m. R. = with the radius, MOQ = Minimum Order Quantity.

\*\* MOQ: Parts with MOQ, set-up costs may apply.

We exclusively sell to the trade and industry. Please note our minimum order quantities and the minimum order value per delivery. We would be pleased to send you an offer that is tailored to your needs should you require special colours, deviating dimensions, bioplastics, or larger order quantities.

## Height adjustment

Application: for round tubes  
Material: acrylonitrile butadiene styrene  
Standard-Colour: black

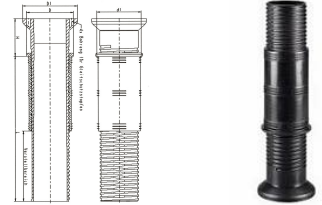

Order No.	Tube outside Ø	Rib Ø	Screwed in spindle	Base outside Ø	Total length	Adjustment range	Colour	PU*	MOQ**
	D	d1	H	D1	L				
13061.00	50 x 1,5	47,3	20,5	50,0	213	120	black	75	-
13065.00	60 x 1,5	57,3	20,5	60	213	120	black	50	100
13059.00	60 x 2	56,3	20,5	60	213	120	black	50	350
13062.00	50 x 1,5	47,3	20,5	60	313	200	black	60	240
13058.00	60 x 2	56,3	20,5	66	213	120	black	50	350
13064.00	60 x 1,5	57,3	20,5	66	213	120	black	50	100
13055.00	50 x 2	46,3	20,5	60	313	200	black	60	180
13054.00	50 x 2	46,3	20,5	50,0	213	120	black	75	300
13060.00	50 x 1,5	47,3	20,5	60,0	213	120	black	80	-
13053.00	50 x 2	46,3	20,5	60,0	213	120	black	50	-
13056.00	55 x 2	51,2	20,5	65,0	213	120	black	50	-
13063.00	60 x 1,5	57,3	20,5	70,0	213	120	black	50	-
13057.00	60 x 2	56,3	20,5	70,0	213	120	black	50	-

Please note that the product illustrations are exemplary images that could deviate from the ordered/delivered products.

All of the dimensions are in mm should nothing to the contrary be stated.

\*PU = Packaging Unit, SW = Spanner opening, n.w. = not detachable, o. K. = excl. The head, o. B. = excl. The collar, m. R. = with the radius, MOQ = Minimum Order Quantity.

\*\* MOQ: Parts with MOQ, set-up costs may apply.

We exclusively sell to the trade and industry. Please note our minimum order quantities and the minimum order value per delivery. We would be pleased to send you an offer that is tailored to your needs should you require special colours, deviating dimensions, bioplastics, or larger order quantities.

## Adjustable feet with plastic trapezoid thread

Application: for square and rectangular tubes  
Material: polyamide  
Standard-Colour: black

JL 1

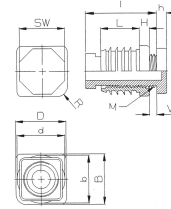

Order No.	Tube dimension	Height	Ribbed section	Length	Adjusting screw	SW	Radius	Colour	PU*	MOQ**
	D x B	H	d x b	L	M x l x h		R			
13163.00	30x30x1-2	6,0	28,7x28,7	23,0	20x4x20x5,0	27	-	black	500	-
13164.00	30x30x1-2	6,0	28,7x28,7	23,0	20x4x20x5,0	27	R6	black	500	2000

Please note that the product illustrations are exemplary images that could deviate from the ordered/delivered products.

All of the dimensions are in mm should nothing to the contrary be stated.

\*PU = Packaging Unit, SW = Spanner opening, n.w. = not detachable, o. K. = excl. The head, o. B. = excl. The collar, m. R. = with the radius, MOQ = Minimum Order Quantity.

\*\* MOQ: Parts with MOQ, set-up costs may apply.

We exclusively sell to the trade and industry. Please note our minimum order quantities and the minimum order value per delivery. We would be pleased to send you an offer that is tailored to your needs should you require special colours, deviating dimensions, bioplastics, or larger order quantities.

## Adjustable feet with plastic thread

Application: for square and rectangular tubes  
Material: polyethylene, polyamide  
Standard-Colour: black

JL 2

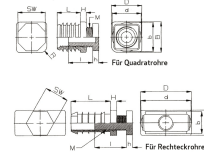

Order No.	Tube dimension	Tube wall thickness	Height	Ribbed section	Length	Adjusting screw	SW	Radius	Material	Colour	PU*	MOQ**
	D x B		H	d x b	L	M x l x h		R				
13066.00	20x20	1,5-2	5,0	17,4x17,4	17,0	10x24x4,0	20	-	PA	black	1750	-
13071.00	25x25	1-2	5,5	23,3x23,3	25,0	16x26x6,0	27	-	PE	black	1000	-
13116.00	25x25	1-2	5,5	23,3x23,3	25,0	16x26x6,0	27	R6	PE	black	1000	2000
13081.00	30x30	1-2	5,5	28,6x28,6	23,0	20x25x6,0	27	-	PE	black	1000	-
13118.00	30x30	1-2	5,5	28,6x28,6	23,0	20x25x6,0	27	R6	PE	black	1000	-
13087.00	35x35	1,5	5,0	32,5x32,5	29,2	22x20x5,0	28	-	PA	black	550	-
13092.00	40x40	1,5 - 2	5,0	37,0x37,0	29,0	22x20x5,0	28	-	PA	black	425	-
13080.00	30x20	1-2	5,0	28,5x18,0	32,0	12x27x5,0	20	-	PA	black	1250	-
13090.00	40x20	1,5	5,0	39,5x17,5	32,0	12x27x5,0	20	-	PA	black	1000	-
13091.00	40x30	1-2	5,0	38,5x28,5	32,0	22x30x5,0	28	-	PA	black	700	-
13122.00	40x30	3	5,0	35,0x25,0	32,0	22x30x5,0	28	-	PA	black	250	-
13101.00	50x20	1-2	5,0	48,5x18,5	32,0	12x30x5,0	20	-	PA	black	750	-
13104.00	60x30	1-2	5,0	58,5x28,5	32,0	22x47x5,0	27	-	PA	black	500	-

Please note that the product illustrations are exemplary images that could deviate from the ordered/delivered products.

All of the dimensions are in mm should nothing to the contrary be stated.

\*PU = Packaging Unit, SW = Spanner opening, n.w. = not detachable, o. K. = excl. The head, o. B. = excl. The collar, m. R. = with the radius, MOQ = Minimum Order Quantity.

\*\* MOQ: Parts with MOQ, set-up costs may apply.

! We exclusively sell to the trade and industry. Please note our minimum order quantities and the minimum order value per delivery. We would be pleased to send you an offer that is tailored to your needs should you require special colours, deviating dimensions, bioplastics, or larger order quantities.

## Adjustable feet with plastic trapezoid thread

Application: for square and rectangular tubes  
Material: polyethylene  
Standard-Colour: black

JL 3

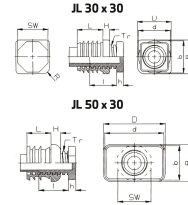

Order No.	Tube dimension	Height	Ribbed section	Length	Adjusting screw	SW	Radius	Colour	PU*	MOQ**
	D x B	H	d x b	L	Tr x l x h		R			
13156.00	30x30x1-2	6,0	28,7x28,7	22,0	20x4x20x5,0	27	-	black	500	-
13158.00	30x30x1-2	6,0	28,7x28,7	22,0	20x4x20x5,0	27	R6	black	500	2000
13157.00	50x30x1,5	9,5	48,5x28,3	20,0	20x4x20x5,0	27	-	black	500	2000

Please note that the product illustrations are exemplary images that could deviate from the ordered/delivered products.

All of the dimensions are in mm should nothing to the contrary be stated.

\*PU = Packaging Unit, SW = Spanner opening, n.w. = not detachable, o. K. = excl. The head, o. B. = excl. The collar, m. R. = with the radius, MOQ = Minimum Order Quantity.

\*\* MOQ: Parts with MOQ, set-up costs may apply.

We exclusively sell to the trade and industry. Please note our minimum order quantities and the minimum order value per delivery. We would be pleased to send you an offer that is tailored to your needs should you require special colours, deviating dimensions, bioplastics, or larger order quantities.

## Adjustable feet with plastic thread and internal safety ring

Application: for square tubes  
Material: polyethylene  
Standard-Colour: black

JLA 1

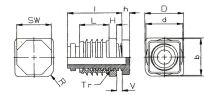

Order No.	Tube dimension	Height	Ribbed section	Length	Adjusting screw	SW	Radius	Colour	PU*	MOQ**
	D x B	H	d x b	L	M x l x h		R			
13170.00	30x30x1-2	5,5	28,6x28,6	23,0	20x41x6,0	27	-	black	500	2000
13171.00	30x30x1-2	5,5	28,6x28,6	23,0	20x41x6,0	27	R6	black	500	2000

Please note that the product illustrations are exemplary images that could deviate from the ordered/delivered products.

All of the dimensions are in mm should nothing to the contrary be stated.

\*PU = Packaging Unit, SW = Spanner opening, n.w. = not detachable, o. K. = excl. The head, o. B. = excl. The collar, m. R. = with the radius, MOQ = Minimum Order Quantity.

\*\* MOQ: Parts with MOQ, set-up costs may apply.

We exclusively sell to the trade and industry. Please note our minimum order quantities and the minimum order value per delivery. We would be pleased to send you an offer that is tailored to your needs should you require special colours, deviating dimensions, bioplastics, or larger order quantities.

## Adjustable feet with plastic thread and internal safety ring

Application: for square and rectangular tubes  
Material: polyethylene  
Standard-Colour: black

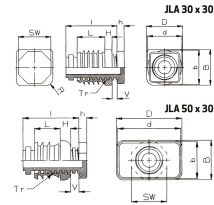

Order No.	Tube dimension	Height	Ribbed section	Length	Adjusting screw	SW	Radius	Colour	PU*	MOQ**
	D x B	H	d x b	L	Tr x l x h		R			
13176.00	30x30x1-2	6,0	28,6x28,6	22,0	20x4x42x5,0	27	-	black	500	2000
13178.00	30x30x1-2	6,0	28,6x28,6	22,0	20x4x42x5,0	27	R6	black	500	2000
13177.00	50x30x1,5	9,5	48,5x28,3	20,0	20x4x42x5,0	27	-	black	500	2000

Please note that the product illustrations are exemplary images that could deviate from the ordered/delivered products.

All of the dimensions are in mm should nothing to the contrary be stated.

\*PU = Packaging Unit, SW = Spanner opening, n.w. = not detachable, o. K. = excl. The head, o. B. = excl. The collar, m. R. = with the radius, MOQ = Minimum Order Quantity.

\*\* MOQ: Parts with MOQ, set-up costs may apply.

We exclusively sell to the trade and industry. Please note our minimum order quantities and the minimum order value per delivery. We would be pleased to send you an offer that is tailored to your needs should you require special colours, deviating dimensions, bioplastics, or larger order quantities.

## Height adjustment

Application: for square tubes  
Material: polyamide GF  
Standard-Colour: black

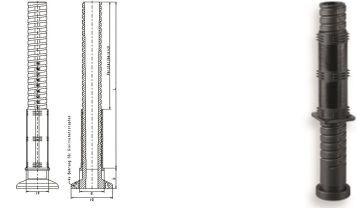

Order No.	Tube dimension	Rib Ø	Screwed in spindle	Base outside Ø	Total length	Adjustment range	Colour	PU*	MOQ**
	D	d1	H	D1	L				
13110.00	40x40x1,5	37,5x37,5	20,5	68	283,5	170	black	50	200
13113.00	40x40x1,5	37,5x37,5	20,5	68	198,5	100	black	100	200
13109.00	40x40x1,5	37,5x37,5	20,5	40	283,5	170	black	100	-
13112.00	40x40x1,5	37,5x37,5	20,5	40	198,5	100	black	100	200
13070.00	40 x 40 x 2	36,5 x 36,5	20,5	68	283,5	170	black	50	200
13086.00	40 x 40 x 2	36,5 x 36,5	20,5	68	198,5	100	black	50	200
13097.00	40 x 40 x 2	36,5 x 36,5	20,5	40	283,5	170	black	100	-
13098.00	40 x 40 x 2	36,5 x 36,5	20,5	40	198,5	100	black	100	-

Please note that the product illustrations are exemplary images that could deviate from the ordered/delivered products.

All of the dimensions are in mm should nothing to the contrary be stated.

\*PU = Packaging Unit, SW = Spanner opening, n.w. = not detachable, o. K. = excl. The head, o. B. = excl. The collar, m. R. = with the radius, MOQ = Minimum Order Quantity.

\*\* MOQ: Parts with MOQ, set-up costs may apply.

We exclusively sell to the trade and industry. Please note our minimum order quantities and the minimum order value per delivery. We would be pleased to send you an offer that is tailored to your needs should you require special colours, deviating dimensions, bioplastics, or larger order quantities.

## Height adjustment

Application: for square tubes  
Material: acrylonitrile butadiene styrene  
Standard-Colour: black

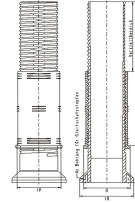

Order No.	Tube dimension	Rib dimension $\emptyset$	Screwed in spindle	Base outside $\emptyset$	Base outside	Total length	Adjustment range	Colour	PU*	MOQ**
	D	d1	H	D1	D1 x D1	L				
13089.00	50x50x1,5	47,5x47,5	20,5	50,0	-	213	120	black	80	-
13077.00	60x60x2	56,5x56,5	20,5	66	-	213	120	black	50	100
13076.00	60x60x2	56,5x56,5	20,5	60	-	213	120	black	50	-
13074.00	50x50x2	46,5x46,5	20,5	60	-	313	200	black	60	-
13073.00	50x50x2	46,5x46,5	20,5	50,0	-	213	120	black	75	-
13088.00	50x50x1,5	47,5x47,5	20,5	60,0	-	213	120	black	50	-
13072.00	50x50x2	46,5x46,5	20,5	60,0	-	213	120	black	50	-
13100.00	50x50x2	46,5x46,5	20,5	-	50x50	213	120	black	100	-
13103.00	50x50x1,5	47,5x47,5	20,5	-	50x50	213	120	black	100	-
13075.00	60x60x2	56,5x56x5	20,5	70,0	-	213	120	black	50	-

Please note that the product illustrations are exemplary images that could deviate from the ordered/delivered products.

All of the dimensions are in mm should nothing to the contrary be stated.

\*PU = Packaging Unit, SW = Spanner opening, n.w. = not detachable, o. K. = excl. The head, o. B. = excl. The collar, m. R. = with the radius, MOQ = Minimum Order Quantity.

\*\* MOQ: Parts with MOQ, set-up costs may apply.

We exclusively sell to the trade and industry. Please note our minimum order quantities and the minimum order value per delivery. We would be pleased to send you an offer that is tailored to your needs should you require special colours, deviating dimensions, bioplastics, or larger order quantities.

## Height adjustment

Application: for square tubes  
Material: ABS  
Standard-Colour: black

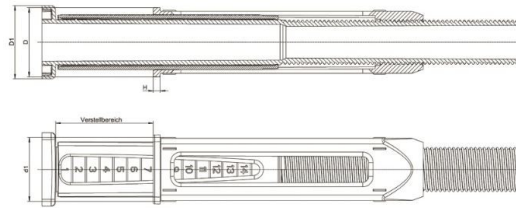

Order No.	Tube dimension	Rib dimension	Flange height	Foot dimension	Adjustment range	Colour	PU*	MOQ**
	D	d1	H	D1				
13111.00	50x50x2	46,8x46,8	5,0	53,0x53,0	0-140	black	60	-

Please note that the product illustrations are exemplary images that could deviate from the ordered/delivered products.

All of the dimensions are in mm should nothing to the contrary be stated.

\*PU = Packaging Unit, SW = Spanner opening, n.w. = not detachable, o. K. = excl. The head, o. B. = excl. The collar, m. R. = with the radius, MOQ = Minimum Order Quantity.

\*\* MOQ: Parts with MOQ, set-up costs may apply.

We exclusively sell to the trade and industry. Please note our minimum order quantities and the minimum order value per delivery. We would be pleased to send you an offer that is tailored to your needs should you require special colours, deviating dimensions, bioplastics, or larger order quantities.